

Indexable and Carbide Tipped

Port Tooling

SAEJ1926 / AS5202
in stock / now available

See back for
complete carbide
tipped offering.

Carbide Tipped Port Tooling

- Coolant thru
- Center ground within .0002" concentricity
- Large number of stock standard sizes
- Three helical flute design for superior finish, chip evacuation and stable cutting forces

Indexable Port Tooling (SAEJ1926 stock)

- Coolant thru standard
- Economical
- ISO standard carbide inserts and single form insert
- Available in multiple grades
- Run at coated carbide speeds

Custom Port Tooling

- Quick quote and delivery
- Designed utilizing ISO standard carbide inserts
- Custom form inserts designed as needed
- Combine operations - reducing set-up and cycle times



Your single source for indexable, carbide tipped and custom tools.

View custom tooling and our complete catalog at www.everede.net
or call us with your application.

E **EVEREDE TOOL COMPANY**
5296 Northwest Highway
Chicago, Illinois 60630
Phone: (773) 467-4200
Toll Free: (800) 621-5486
www.everede.net

DURAMILL
INDUSTRIAL SUPPLIES INC.

21 Bradwick Drive, Suites 2-3, Concord, ON L4K 1K6
Tel: (905) 738-8665 Fax: (905) 738-4862
www.duramill.ca ■ sales@duramill.ca

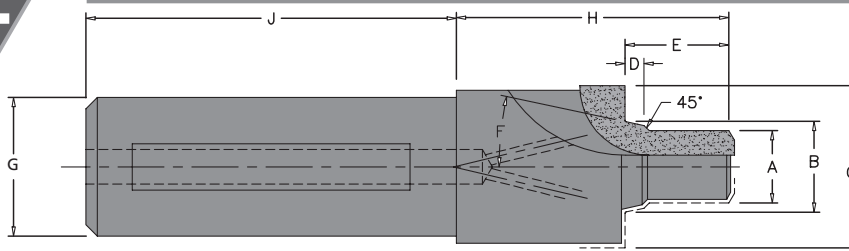

All cutters have 3 carbide tipped flutes.

SAE J1926/MS16142 (Series PC) with coolant thru

EVEREDE PART NUMBER	PORT SIZE	PRE DRILL SIZE	TUBE #	A	B ± .002	C	D ± .008	E	G	H	J	LIST PRICE*
				DIA.	DIA.	MIN. DIA.	LENGTH	MIN. LENGTH	-0.0005 -0.0010	LENGTH	LENGTH	
CTPC-312-24	5/16-24	0.25	2	0.272	0.360	0.669	0.083	0.472	1/2	1-1/2	2	\$170.00
CTPC-375-24	3/8-24	0.31	3	0.335	0.423	0.748	0.083	0.472	1/2	1-1/2	2	\$170.00
CTPC-438-20	7/16-20	0.37	4	0.389	0.490	0.827	0.102	0.551	1/2	1-1/2	2	\$170.00
CTPC-500-20	1/2-20	0.44	5	0.452	0.553	0.906	0.102	0.551	1/2	1-1/2	2	\$175.00
CTPC-562-18	9/16-18	0.48	6	0.509	0.618	0.984	0.106	0.610	1/2	1-1/2	2	\$175.00
CTPC-750-16	3/4-16	0.67	8	0.689	0.813	1.181	0.106	0.689	3/4	1-1/2	2	\$192.00
CTPC-875-14	7/8-14	0.78	10	0.806	0.945	1.339	0.106	0.787	3/4	2	2	\$215.00
CTPC-1.062-12	1 1/16-12	0.95	12	0.981	1.150	1.614	0.138	0.906	3/4	2	2	\$232.00
CTPC-1.188-12	1 3/16-12	1.09	14	1.106	1.276	1.772	0.138	0.906	3/4	2	2	\$240.00
CTPC-1.312-12	1 5/16-12	1.21	16	1.231	1.400	1.929	0.138	0.906	3/4	2	2	\$255.00
CTPC-1.625-12	1 5/8-12	1.53	20	1.544	1.715	1.283	0.138	0.906	3/4	2	2	\$285.00
CTPC-1.875-12	1 7/8-12	1.78	24	1.794	1.965	2.559	0.138	0.906	3/4	2	2	\$356.00

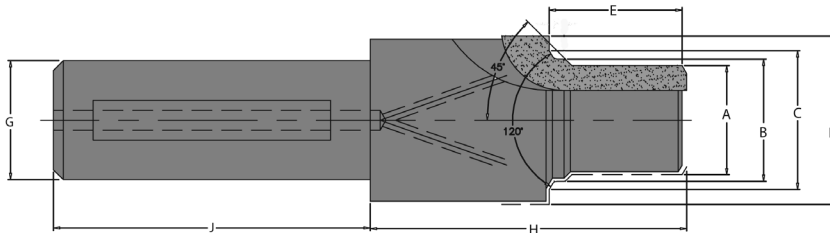

All cutters have 3 carbide tipped flutes.

SAE AS5202/MS33649 (Series PC) with coolant thru

EVEREDE PART NUMBER	PORT SIZE (UNJF & UNJ)	PRE DRILL SIZE	TUBE #	A	B + .005 - .000	C + .015 - .000	D	E	G	H	J	LIST PRICE*
				DIA.	DIA.	DIA.	MIN DIA.	MIN. LENGTH	-0.0005 -0.0010	LENGTH	LENGTH	
CTPC-375-24-649	3/8-24	0.31	3	.335	.390	.500	.688	.588	1/2	1-1/2	2	\$170.00
CTPC-438-20-649	7/16-20	0.37	4	.389	.454	.562	.750	.661	1/2	1-1/2	2	\$170.00
CTPC-500-20-649	1/2-20	0.43	5	.452	.517	.625	.812	.661	1/2	1-1/2	2	\$175.00
CTPC-562-18-649	9/16-18	0.49	6	.515	.580	.688	.875	.714	1/2	1-1/2	2	\$175.00
CTPC-625-18-649	5/8-18	0.55	7	.578	.643	.750	.938	.730	1/2	1-1/2	2	\$192.00
CTPC-750-16-649	3/4-16	0.66	8	.689	.769	.875	1.062	.839	3/4	1-1/2	2	\$192.00
CTPC-875-14-649	7/8-14	0.77	10	.797	.896	1.000	1.188	.935	3/4	2	2	\$215.00
CTPC-1.062-12-649	1 1/16-12	0.96	12	.981	1.086	1.234	1.438	1.069	3/4	2	2	\$232.00
CTPC-1.188-12-649	1 3/16-12	1.08	14	1.106	1.211	1.362	1.562	1.069	3/4	2	2	\$240.00
CTPC-1.312-12-649	1 5/16-12	1.21	16	1.231	1.336	1.487	1.688	1.069	3/4	2	2	\$255.00
CTPC-1.625-12-649	1 5/8-12	1.52	20	1.544	1.648	1.800	2.000	1.121	3/4	2	2	\$285.00
CTPC-1.875-12-649	1 7/8-12	1.77	24	1.794	1.898	2.050	2.250	1.132	3/4	2	2	\$356.00

*Pricing subject to change